

KEY PLAN

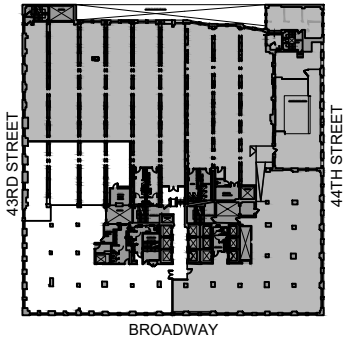

SUITE 1010

WORKSPACE	SEATS
EXECUTIVE OFFICE	1
PRIVATE OFFICE	6
BENCHING (5'X30")	44
RECEPTION	1
TOTAL HEADCOUNT	52

COLLAB SPACE	QNTY
CONFERENCE ROOM	1
MEETING ROOM	5
PHONE ROOM	3
OPEN COLLAB AREA	3

SUPPORT	QNTY
PANTRY	1
COAT CLOSET	1
COPY AREA	1
STORAGE ROOM	1
IT ROOM	1